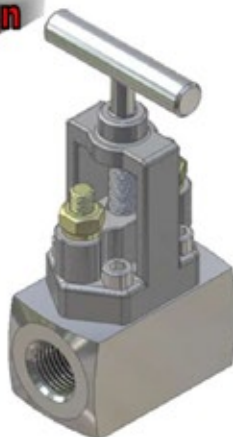
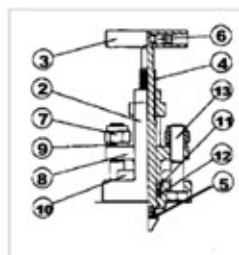
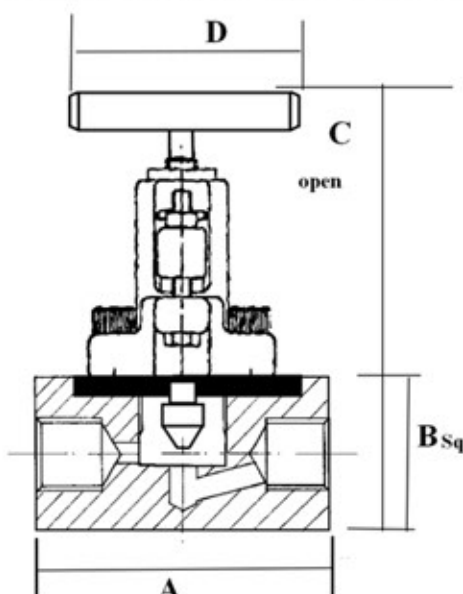

'NO2' Series OS&Y NEEDLE VALVE**6,000 psi [Pn 414] Rated 10,000 psi [Pn 690] Rated****Fire Tested Design
to BS 6755 Pt 2****DESIGN FEATURES**

- * OS&Y Bonnet
- * Robust HIGH pressure design
- * DESIGNED to be maintained
- * NON-Rotating tip as standard
- * TIP Hardened for effective shut-off and life
- * Low operating torque
- * Smooth 5 turns from OPEN to CLOSE
- * Back sealing on the stem
- * 316ss to NACE Specification
- * Wide range of thread forms available
- * Adjustable gland packing
- * Full material traceability
- * Stem Seal below actuating threads to prevent contamination & gauling of threads
- * Metal/Metal bonnet seal for pressure tightness even at elevated temperatures.

MATERIALS of CONSTRUCTION - 316 Stainless Steel**OS&Y HEAD ASSY**

ITEM	COMPONENT	MATERIAL
1	FLANGE BODY	316 S 11 *
2	BONNET HOUSING	316 S 11 *
3	HANDLE	316 S 11 *
4	STEM	316 S 11 *
5	STEM TIP	17 / 4 PH *
6	GRUB SCREW	STAINLESS STEEL
7	YOKE NUT	STAINLESS STEEL
8	YOKE	316 S 11
9	SPRING WASHER	STAINLESS STEEL
10	CAP SCREW	STAINLESS STEEL
11	GLAND	316 S 11
12	GLAND PACKING	PIPE / GRAPHOIL
13	YOKE ADJUST BOLT	STAINLESS STEEL

Valve Size	A	B	C	D	Wt Kgs
15-1/2"	60	38	130	60	0.50
10-3/4"	65	38	130	60	0.90

Sample Part Number NO2SP0815NFS

1/2" NPT Female 316 St. St. Needle Valve, 8mm Bore - 6,000 psi/Pn 414 Rated, fitted OS&Y Bonnet.

VALVE PART NUMBER and ORDERING TABLE

Valve Series	Bore Size	Size	Inlet/Outlet Threads	* Material	Options
NO2S P 6,000 psi/Pn414	08	15 -1/2"	NF -NPT Female NM -NPT Male	D - 31803 Duplex H - Hasteloy I - Incoloy J - 6Mo L - LF2 M - Monel S - 316 SS U - 32760 S.Duplex	-G Graphoil Packing -HS Handwheel 316 St. St.
NO2S X 10,000 psi/Pn690		20 - 3/4"	PF -BSPP Female PM-BSPP Male TF -BSPT Female TM -BSPT Male		

We reserve the right to change specifications stated in this leaflet due to our continuing programme of development.

Valves are supplied as standard with 'T' Bar Handle.

NO2S-09/09